

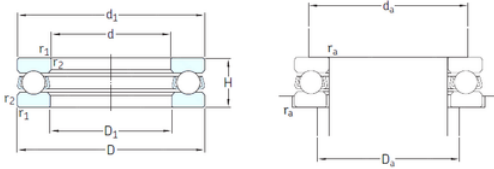

Lamar parts manufacturing company



SKF 51218 thrust ball bearings

Bearing No. 51218

Size	90x135x35 mm
Bore Diameter	90 mm
Outer Diameter	135 mm
Width	35 mm
d	90 mm
D	135 mm
H	35 mm
d1	135 mm
r1 min.	1,1 mm
r2 min.	1,1 mm
D1	93 mm
da min.	117 mm
Da max.	108 mm
ra max.	1 mm
Weight	1,7 Kg
Basic dynamic load rating (C)	112 kN
Basic static load rating (C0)	290 kN
Fatigue load limit (Pu)	10,4
Reference speed	2000 r/min
Limiting speed	2800 r/min
Category	Thrust Ball Bearing
Inventory	0.0
Manufacturer Name	SKF
Minimum Buy Quantity	N/A
Weight / Kilogram	1.68
EAN	7316577006820

51218 Bearing 2D drawings and 3D CAD models



Lamar parts manufacturing company

Product Group	B00308
Rolling Element	Ball Bearing
Thrust Bearing	Yes
Single or Double Direction	Single Direction
Banded	No
Cage Material	Steel
Precision Class	ABEC 1 ISO P0
Component Description	Roller Assembly Plus Raceways
Other Features	Single Row
Long Description	90MM Bore 1; 93MM Bore 2; 135MM Outside Diameter; 35MM Height; Ball Bearing; Single Direction; Not Banded; Steel Cage; ABEC 1 ISO P0 Precision
Inch - Metric	Metric
Category	Thrust Ball Bearings
UNSPSC	31171507
Harmonized Tariff Code	8482.10.50.08
Noun	Bearing
Keyword String	Ball Thrust
Manufacturer URL	http://www.skf.com
Manufacturer Item Number	51218
Weight / LBS	3.709
Outside Diameter	5.315 Inch 135 Millimeter
Overall Height with Aligning Washer	0 Inch 0 Millimeter
Bore 2	3.661 Inch 93 Millimeter
Height	1.378 Inch 35 Millimeter
Bore 1	3.543 Inch 90 Millimeter
bore diameter:	90 mm
static load capacity:	290 kN



Lamar parts manufacturing company

outside diameter:	135 mm
dynamic load capacity:	112 kN
overall width:	35 mm
maximum rpm:	2800 RPM
thrust bearing type:	Single-Direction
cage material:	Steel
outside diameter design:	Straight
fillet radius:	1 mm
separable or banded:	Separable
series:	512
precision rating:	ABEC 1 (ISO Class Normal)
d_1	135 mm
D_1	93 mm
$r_{1,2}$ min.	1.1 mm
d_a min.	117 mm
D_a max.	108 mm
r_a max.	1 mm
Basic dynamic load rating C	112 kN
Basic static load rating C_0	290 kN
Fatigue load limit P_u	10.4 kN
Minimum load factor A	0.55
Mass bearing (including seat washer where applicable)	1.7 kg