

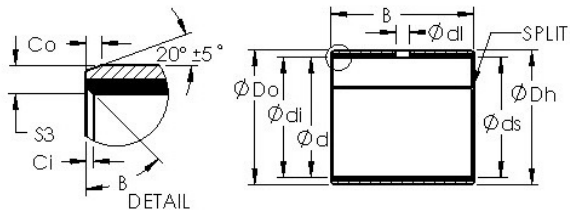

Lamar parts manufacturing company



AST AST50 112IB36 plain bearings

Bearing No. AST50 112IB36

Bore Diameter	177,8 mm
Bearing Type	straight
Shaft Dia., Nominal (d)	7.0000
Shaft Size (ds) - 6.9954	6.9929
Housing Bore Dia. (Dh) - 7.183	7.1812
Bearing Bore after Mounting (di) - 7.0026	6.9956
Average Clearance (Cd)	0.0048
Wall Thickness (S3)	0.095
Bearing Length, Nominal (B)	2.250
Bearing Length Tolerance (B tol.) - +.010 / -0.010	+0.010 / 0.010
OD Chamfer Length (Co)	0.072
ID Chamfer Angle (B deg.)	30
ID Chamfer Length (Ci)	0.031
Material	Carbon steel shell with PTFE / Fiber lining

AST50 112IB36 Bearing 2D drawings and 3D CAD models