

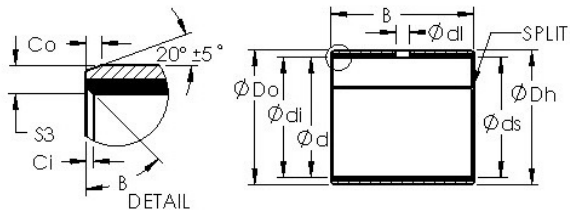

# Lamar parts manufacturing company



## AST AST50 24IB08 plain bearings

Bearing No. AST50 24IB08

Bore Diameter	38,1 mm
Bearing Type	straight
Shaft Dia., Nominal (d)	1.5000
Shaft Size (ds) - 1.4988	1.4972
Housing Bore Dia. (Dh) - 1.6568	1.6558
Bearing Bore after Mounting (di) - 1.5028	1.499
Average Clearance (Cd)	0.0029
Wall Thickness (S3)	0.079
Bearing Length, Nominal (B)	0.500
Bearing Length Tolerance (B tol.) - +.010 / -0.010	+0.010 / 0.010
OD Chamfer Length (Co)	0.045
ID Chamfer Angle (B deg.)	30
ID Chamfer Length (Ci)	0.020
Material	Carbon steel shell with PTFE / Fiber lining

AST50 24IB08 Bearing 2D drawings and 3D CAD models