

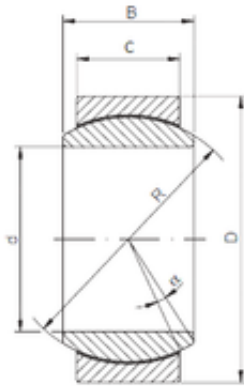

Lamar parts manufacturing company

20 mm x 35 mm x 16 mm ISO GE20UK-2RS
plain bearings



Bearing No. GE20UK-2RS

Size	20x35x16 mm
Bore Diameter	20 mm
Outer Diameter	35 mm
Width	16 mm
d	20 mm
D	35 mm
B	16 mm
C	12 mm
R	29 mm
Angle	9 °

GE20UK-2RS Bearing 2D drawings and 3D CAD models