

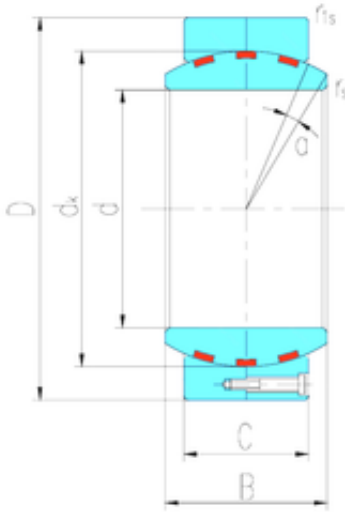

## Lamar parts manufacturing company



750 mm x 1060 mm x 530 mm LS  
GEH750HF/Q plain bearings

Bearing No. GEH750HF/Q

|                               |                 |
|-------------------------------|-----------------|
| Size                          | 750x1060x530 mm |
| Bore Diameter                 | 750 mm          |
| Outer Diameter                | 1060 mm         |
| Width                         | 530 mm          |
| d                             | 750 mm          |
| D                             | 1060 mm         |
| B                             | 530 mm          |
| C                             | 500 mm          |
| dk                            | 972 mm          |
| r min.                        | 3 mm            |
| r1 min.                       | 6 mm            |
| Angle                         | 2 °             |
| Weight                        | 1722 Kg         |
| Basic dynamic load rating (C) | 48600 kN        |

GEH750HF/Q Bearing 2D drawings and 3D CAD models