

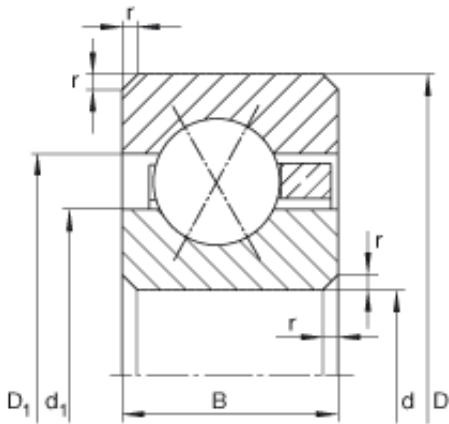

Lamar parts manufacturing company



CSXD120 Bearing 2D drawings and 3D CAD models

12 inch x 330,2 mm x 12,7 mm INA CSXD120 deep groove ball bearings

Bearing No. CSXD120

Size	304.8x330.2x12.7 mm
Bore Diameter	304,8 mm
Outer Diameter	330,2 mm
Width	12,7 mm
d	304,8 mm
d	12 inch
D	330,2 mm
B	12,7 mm
D ₁	320,8 mm
d ₁	314,2 mm
r _{min}	1,5 mm
m	1,02 kg / Weight
C _r	24100 N / Dynamic load rating (radial)
C _{0r}	60000 N / Static load rating (radial)
Category	Angular Contact Ball Bearings
Inventory	0.0
Manufacturer Name	SCHAEFFLER GROUP
Minimum Buy Quantity	N/A
Weight / Kilogram	1.02
Product Group	B00234
Enclosure	Open
Flush Ground	No
Rolling Element	Ball Bearing



Lamar parts manufacturing company

Number of Rows of Balls	Single Row
Precision Class	ABEC 1 ISO P0
Maximum Capacity / Filling Slot	No
Snap Ring	No
Cage Material	Brass
Contact Angle	35 Degree 4 Point
Internal Clearance	C0-Medium
Number of Bearings	1 (Single)
Inch - Metric	Inch
Long Description	12" Bore; 13" Outside Diameter; 1/2" Width; Open; No Flush Ground; Ball Bearing; Single Row of Balls; ABEC 1 ISO P0; No Filling Slot; No Snap Ring; C0-Medium; Brass Cage; 35 Degree
Other Features	Thin Section
Category	Angular Contact Ball Bearing
UNSPSC	31171531
Harmonized Tariff Code	8482.10.50.28
Noun	Bearing
Keyword String	Angular Contact
Manufacturer URL	http://www.ina.com
Weight / LBS	2.17
Outside Diameter	13 Inch 330.2 Millimeter
Bore	12 Inch 304.8 Millimeter
Width	0.5 Inch 12.7 Millimeter