

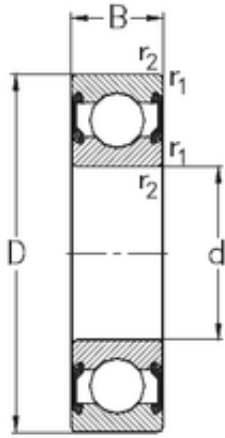

Lamar parts manufacturing company



40 mm x 80 mm x 18 mm NKE 6208-2RS2 deep groove ball bearings

Bearing No. 6208-2RS2

Size	40x80x18 mm
Bore Diameter	40 mm
Outer Diameter	80 mm
Width	18 mm
d	40 mm
D	80 mm
B	18 mm
C	18 mm
r1 min.	1,1 mm
r2 min.	1,1 mm
Weight	0,366 Kg
Basic dynamic load rating (C)	29,5 kN
Basic static load rating (C0)	18,2 kN

6208-2RS2 Bearing 2D drawings and 3D CAD models