

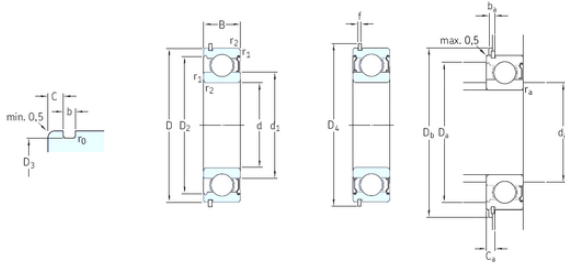

Lamar parts manufacturing company



60 mm x 110 mm x 22 mm SKF 6212-2ZNR deep groove ball bearings

Bearing No. 6212-2ZNR

6212-2ZNR Bearing 2D drawings and 3D CAD models

Size	60x110x22 mm
Bore Diameter	60 mm
Outer Diameter	110 mm
Width	22 mm
d	60 mm
D	110 mm
B	22 mm
C	22 mm
b	2,7 mm
d1	75,5 mm
f	2,46 mm
r0 max.	0,6 mm
r1 min.	1,5 mm
r2 min.	1,5 mm
C	3,28 mm
D2	98 mm
D3	106,81 mm
D4	116,6 mm
ba min.	5,74 mm
Ca max.	5,74 mm
da min.	3 mm
da max	75,4 mm
Da max.	101 mm
Db min.	118 mm
ra max.	1,5 mm



Lamar parts manufacturing company

Weight	0,81 Kg
Basic dynamic load rating (C)	55,3 kN
Basic static load rating (C0)	36 kN
Fatigue load limit (Pu)	1,53
Reference speed	13000 r/min
Limiting speed	8000 r/min
Calculation factor (f0)	14
Category	Single Row Ball Bearings
Inventory	0.0
Manufacturer Name	SKF
Minimum Buy Quantity	N/A
Weight / Kilogram	0.825
EAN	7316570190045
Product Group	B00308
Enclosure	2 Metal Shields
Precision Class	ABEC 1 ISO P0
Maximum Capacity / Filling Slot	No
Rolling Element	Ball Bearing
Snap Ring	Yes
Internal Special Features	No
Cage Material	Steel
Internal Clearance	C0-Medium
Inch - Metric	Metric
Long Description	60MM Bore; 110MM Outside Diameter; 22MM Outer Race Width; 2 Metal Shields; Ball Bearing; ABEC 1 ISO P0; No Filling Slot; Yes Snap Ring; No Internal Special Features; C0-Medium Internal Clearance; St
Other Features	Deep Groove With Snap Ring



Lamar parts manufacturing company

Category	Single Row Ball Bearing
UNSPSC	31171504
Harmonized Tariff Code	8482.10.50.68
Noun	Bearing
Keyword String	Ball
Manufacturer URL	http://www.skf.com
Weight / LBS	1.8033
Inner Race Width	0 Inch 0 Millimeter
Bore	2.362 Inch 60 Millimeter
Outside Diameter	4.331 Inch 110 Millimeter
Outer Race Width	0.866 Inch 22 Millimeter
d_1	75.5 mm
D_2	98 mm
D_3	106.81 mm
D_4	116.6 mm
r_0 max.	0.6 mm
$r_{1,2}$ min.	1.5 mm
d_a min.	69 mm
d_a max.	75.4 mm
D_a max.	101 mm
D_b min.	118 mm
b_a min.	3 mm
C_a max.	5.74 mm
r_a max.	1.5 mm
Basic dynamic load rating C	55.3 kN
Basic static load rating C_0	36 kN
Fatigue load limit P_u	1.53 kN
Calculation factor k_r	0.025
Calculation factor f_0	14
Mass bearing	0.83 kg
Snap ring	SP 110